

Download NMSU VPN on Android

When attempting to access NMSU services off-campus, such as e-mail and myNMSU Banner Self-Service features (Student and Financial Aid, Faculty, Workflow or Employee tabs), your Internet service provider may not allow you access to some of these services. In this situation, you can use install the NMSU VPN Client on your computer and use it to remotely log into the NMSU Campus Network. This allows faculty, staff, and students to access myNMSU Banner Self-Service features, Canvas, and NMSU e-mail from off-campus.

Before going through these steps, please verify that your Mobile device is up to date.

Cisco releases periodic updates to the AnyConnect App to address bugs and compatibility issues. Please make sure the AnyConnect App is kept up to date.

**Note: Quality and reliability are subject to the mobile device's coverage, signal strength, provider, and the mobile device itself.*

1. Download the **Cisco AnyConnect VPN Client** from the **Google Play Store**. When you've downloaded the client, launch the **AnyConnect App**.

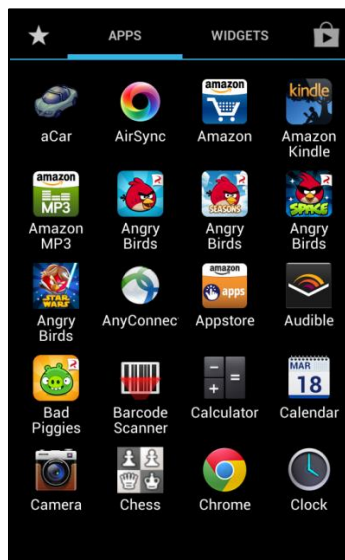

2. Read the **End User License Agreement**. If you accept the agreement, tap **Accept** to continue. If you do not accept the agreement, tap **Decline** to discontinue. Next, tap **Add New VPN Connection...**



3. Set the **Description** to **NMSU** and the **Server Address** to **vpn.nmsu.edu**. Then tap **Done**.



4. Tap on the new **NMSU** connection you just created. Enter your NMSU user name in the **Username** box and your NMSU password in the **Password** box and tap **OK**.

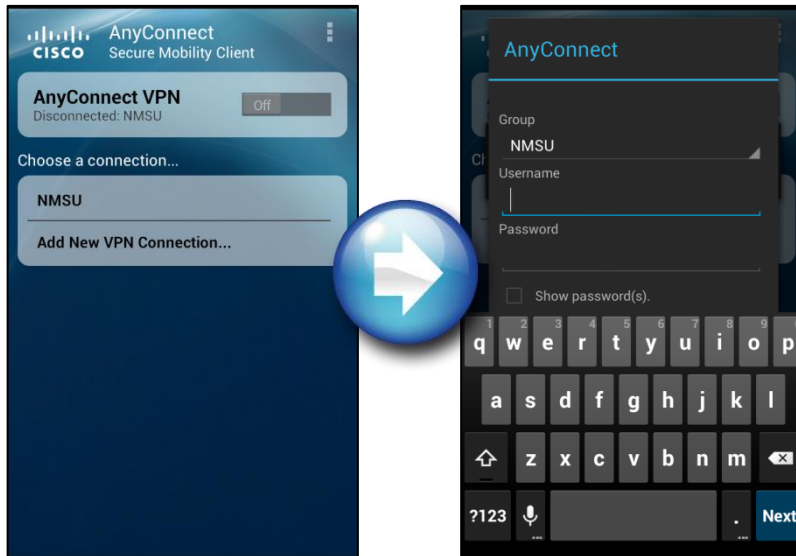

5. On the next screen, read the disclaimer. If you agree, select **I trust this application.** to continue. If you do not agree, tap **Cancel** to discontinue. Then tap **OK**. (Android-9.png)

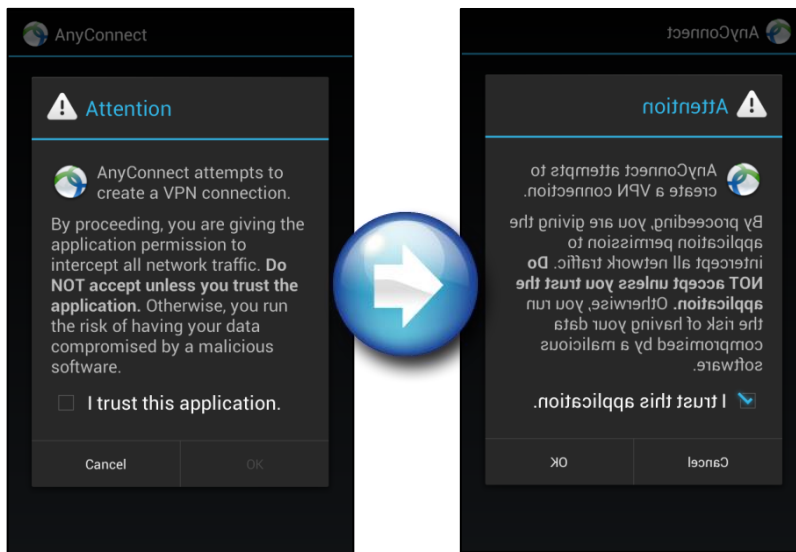

6. You are now connected as indicated by the Key icon in the **Notification Bar** at the top. (Android-10.png)
7. To disconnect, swipe down the **Notification Bar** at the top, access **AnyConnect**, and tap **Disconnect**. (Android-11.png, Android-12.png)

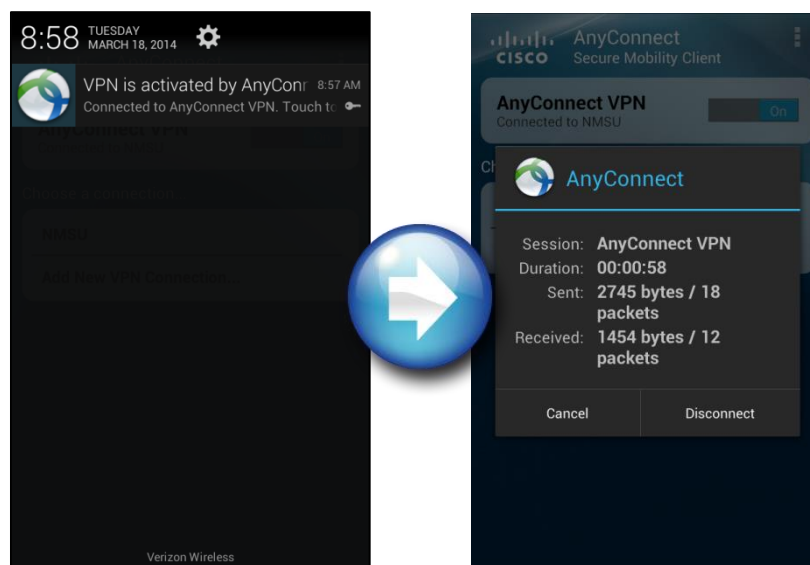
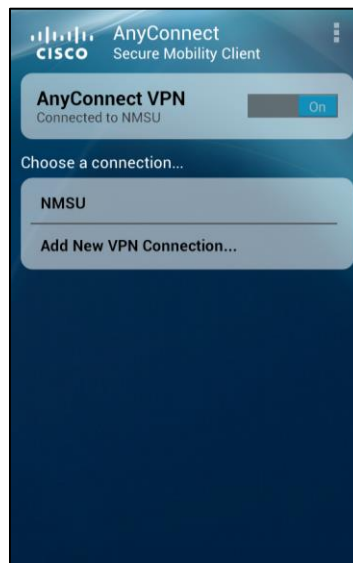

If you have any questions, come by the **ICT Customer Service and Help Desk** in **room 141** of the **Computer Center**, call **646-1840**, or e-mail us at help@nmsu.edu.